

IS-V005 MP3 FM MODULATOR

DC 12V-24V

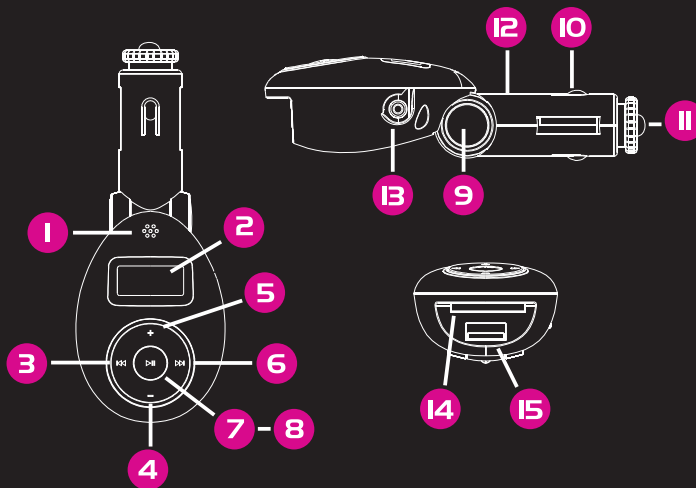

TOP VIEW:

1. Remote Receiver
2. LCD Display
3. Previous Track & Volume (-)
4. FM Frequency (-)
5. FM Frequency (+)
6. Next Track & Volume (+)
7. Play & Pause
8. Power On & Off (Press for 3 Seconds)

SIDE VIEW:

9. Adjustable Hinge
10. Negative Pole
11. Positive Pole (Tip)
12. Cigarette Plug
13. Auxiliary Line-in

REAR VIEW:

14. SD/MMC Card Port
15. USB Port

Technical Specifications

- 206 Preset FM Channel
- 5m FM Broadcasting Range
- 50mWatt FM Broadcasting Output Power
- SD/MMC Slot for SD/MMC Memory Cards
- USB Port for USB Flash Disk & MP3/4 Players
- Auxiliary Line-in For External mp3 Players
- Read/Play MP3 & WMA
- LCD Status Display
- DC 12-24V 0.5A Power Consumption
- Mini-Jack Cable Included (for Audio-Out)
- Fuse Protected

HOW TO USE THE iSONIC MP3 FM MODULATOR:

1. Save your MP3/WMA Files in the ROOT Directory of the disk/memory card (Do Not Use Folders)
2. Plug the FM MODULATOR into your car cigarette lighter.
3. Plug in your Flash Drive/SD Card/MP3 Player/CD Player/Car DVD Player.
4. Tune your Car Radio to a FM Channel supported by the FM Modulator.
5. Press play on the MP3 FM Modulator and enjoy!



Supports:

- ✓ 206 Preset FM Channels
- ✓ SD/MMC Memory Cards
- ✓ USB Flash Drives
- ✓ USB MP3 & MP4 Players
- ✓ Audio devices with Mini-Jack I/O
- ✓ MP3 & WMA File Formats